

TOP VIEW

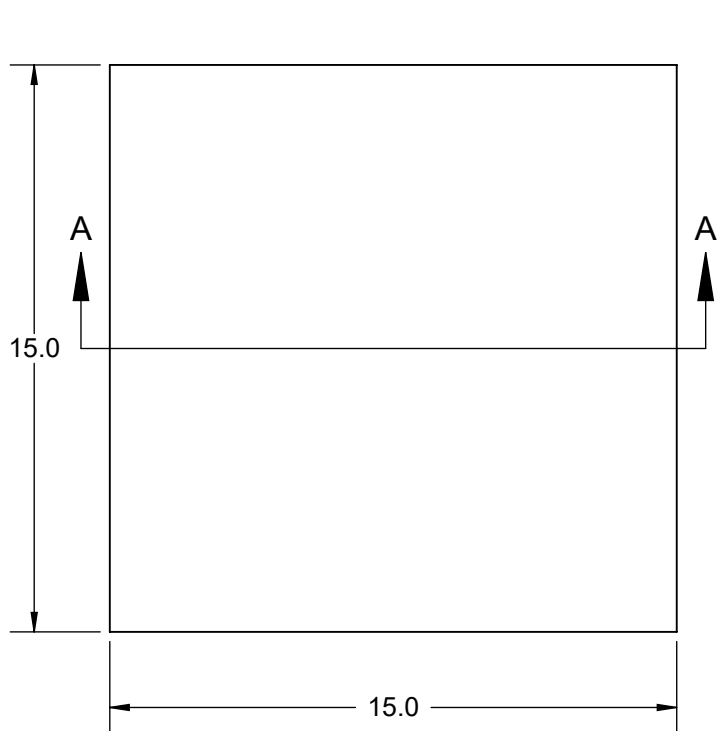

SIDE VIEW

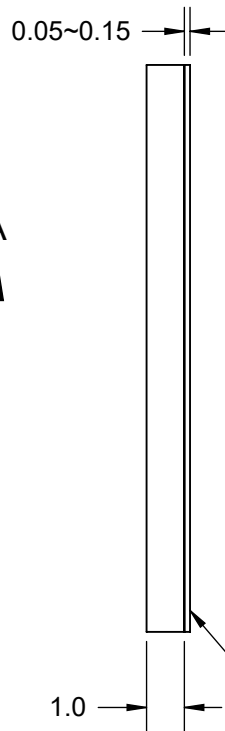

BOTTOM VIEW

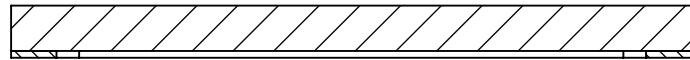
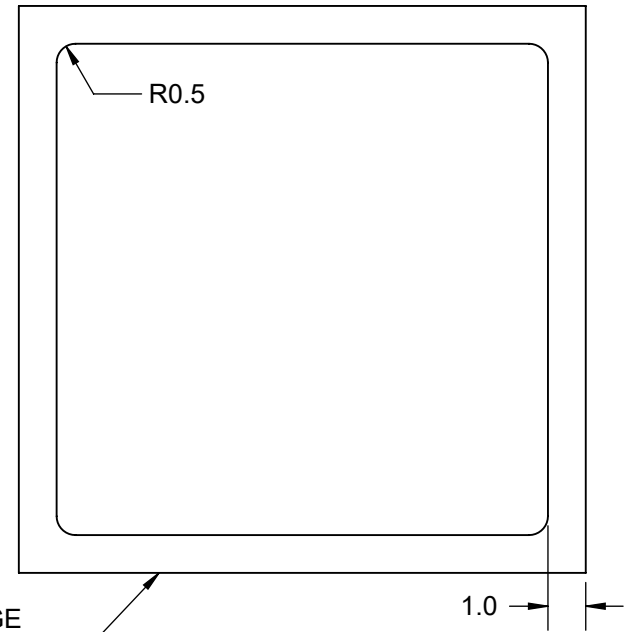

SECTION A-A

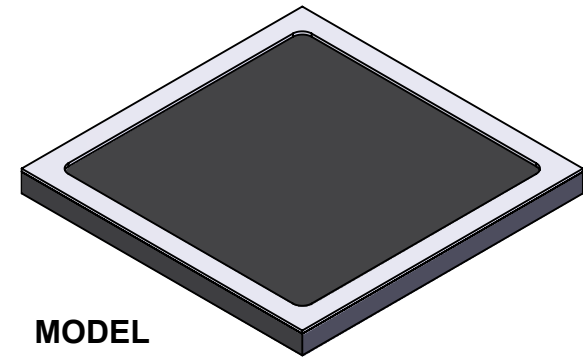

MODEL

NOTES: (Unless Otherwise Specified).

1) MATERIAL:

A) LID: AL₂O₃ BLACK CERAMIC. ALUMINA 91%

B) PREFORM: B-STAGE LCA1000X.

2) CURE: WITH CLAMP PRESSURE 0.035KG/CM SQ. OR 1/2-LBS PER SQUARE INCH.

3) CURE TIME @ 175°C FOR 30 MINUTES OR CURE TIME @ 150°C FOR 60 MINUTES.

4) STORAGE LIFE: 6 MONTHS @ 25°C. 12 MONTHS @ 0°C.

5) DIMENSIONS MM.

APPROVALS	DATE	TopLine®			
DRAWN T. Au	2/10/2023				
ENG M. Hart	2/10/2023	TITLE C-LID15T1.0-BLACK LID 15x15mm ADHESIVE PREFORM			
MFG		SCALE	SIZE	DRAWING NO.	REV
QA		16:1	A	215471	A
CUST		DO NOT SCALE DRAWING			SHEET 1 OF 1
REVISED					